

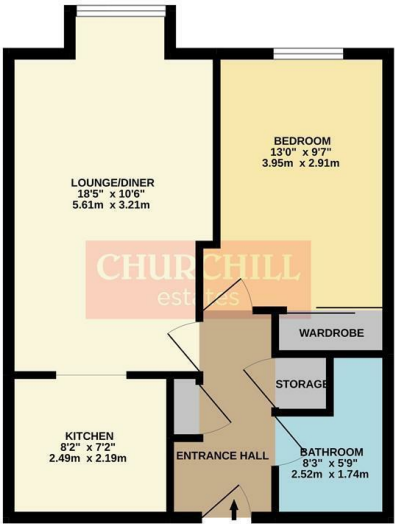

THIRD FLOOR
461 sq.ft. (42.8 sq.m.) approx.



TOTAL FLOOR AREA: 461 sq.ft. (42.8 sq.m.) approx.
While every effort has been made to ensure the accuracy of the floorplan, measurements of rooms, windows, doors and any other items are approximate and no responsibility is taken for any error, omission or misstatement. This plan is for guidance only and should be used as a guide for any prospective purchaser. The actual, physical and legal dimensions of the property may vary from those shown on the plan. No warranty is given.

Council: LBWF | Council Tax Band: B | Floor Area: 461.00 sq ft

Energy Efficiency Rating		
	Current	Potential
Very energy efficient - lower running costs		
(92 plus) A		
(81-91) B		
(69-80) C		
(55-68) D		
(39-54) E		
(21-38) F		
(1-20) G		
Not energy efficient - higher running costs		
England & Wales	EU Directive 2002/91/EC	



The Agent has not tested any apparatus ,equipment, fixtures and fittings or services and so cannot verify that they are in working order or fit for the purpose. A buyer is advised to obtain verification from their solicitor or surveyor.
References to the tenure of a property are based on information supplied by the seller. The agent has not had the sight of the title documents. A buyer is advised to obtain verification from their solicitors.

CHURCHILL
estates



CHURCHILL
estates

1 Teresa Mews, Walthamstow, E17 3BE
Price Guide £350,000 Leasehold

Bedrooms: 1 | Reception Rooms: 1 | Bathrooms: 1



Request a Viewing: **0208 503 6060** Email: **walthamstow@wearechurchills.co.uk**



Nestled in the charming Teresa Mews, London, this delightful one-bedroom house offers a perfect blend of comfort and convenience. Ideal for individuals or couples, the property features a well-appointed bedroom and a bathroom.

With its addition to its prime location, this property has private parking. The flat itself is designed to maximise space and light, creating a warm and inviting atmosphere. Whether you are entertaining guests or enjoying a quiet evening, this property is sure to meet your needs.

This one-bedroom flat in Teresa Mews is an excellent opportunity for those seeking a comfortable and conveniently located home in London. With its close proximity to the station and the luxury of private parking.

